

**Note!**

*Before installing this product, check the contents of the kit. If anything is missing, please contact an Öhlins dealer.*

**Kit Contents**

Description	Part No	Pcs
Shock absorber	YA110013	2
O-ring	00438-01	4
Spacer 20x10x4	60020-01	2
Spacer 20x12x4	60020-02	2
Sticker Öhlins	00192-01	2
Tool preload adjuster	03199-03	1
Owners manual	07241-02	1

**Note!**

*Please note that this image is a general representation of the product and may differ slightly from your product.*

**Note!**

*Please note that during storage and transportation, especially at high ambient temperature, some of the oil and grease used for assembling may leak and stain the packaging. This is in no way detrimental to the product, wipe off the excessive oil/grease with a cloth.*

**Warning!**

*Before installing this product, read the Öhlins Owner's Manual. The shock absorber is an important part of your vehicle and will affect the stability.*

## Shock Absorber for YAMAHA Tricity

# YA110013

## Mounting Instructions

# MOUNTING INSTRUCTIONS

## **Warning!**

*It is advisable to have an Öhlins dealer install the shock absorber.*

## **Warning!**

*If working on a raised vehicle, ensure it is securely supported so that it will not tip over.*

## **Note!**

*Before mounting this product clean the vehicle thoroughly.*

## **Note!**

*When working on this product, always see the Vehicle Service Manual for vehicle specific procedures and important data.*

**1**

Put the motorcycle on the center stand so that the rear wheel barely touches the ground. Make sure the motorcycle is in a stable position.

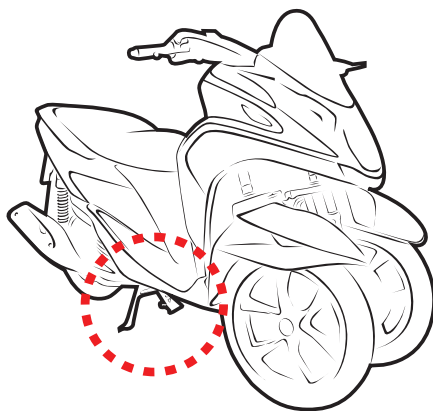

**2**

Open the passenger seat and remove the fuse cover (1). Then loosen the nut (2).

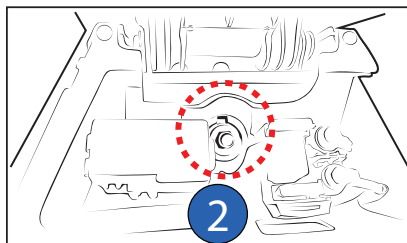
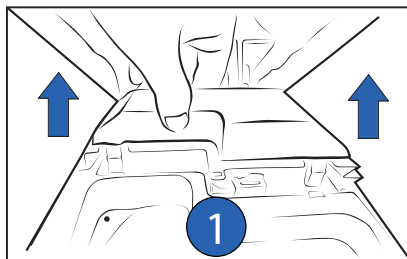
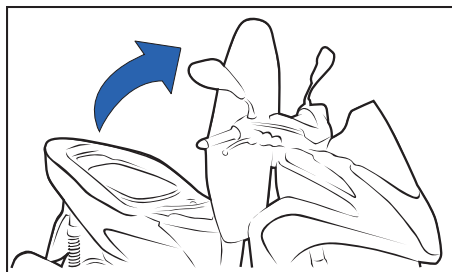

# MOUNTING INSTRUCTIONS

## 3

Release the storage compartment by loosening the four screws (1)(2)(3)(4). Then remove the fuel tank cap (5) and lift up the storage compartment.

Close the fuel tank cap.

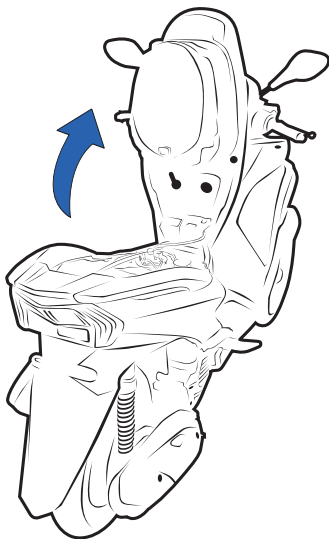
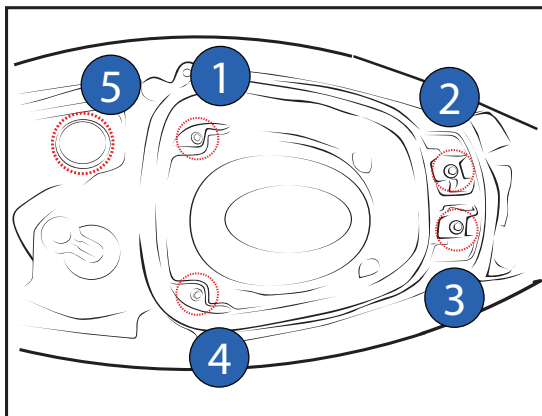

# MOUNTING INSTRUCTIONS

4

Remove the center rear cowl by loosening the two screws (1)(2).

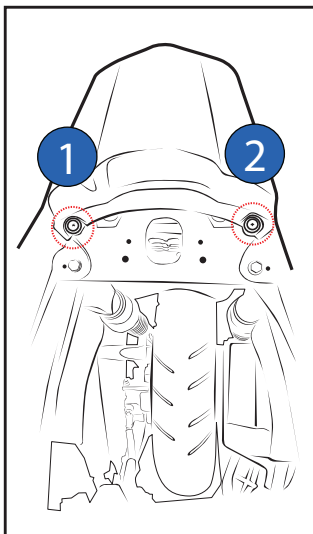

5

Remove the grab bar by loosening the ten screws (1)(2)(3)(4)(5)(6)(7)(8)(9)(10).

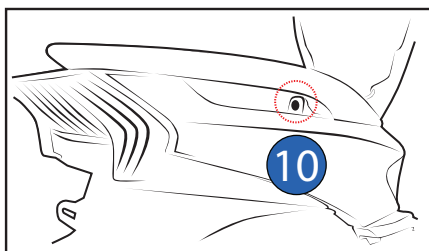
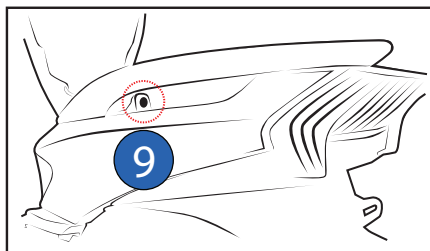
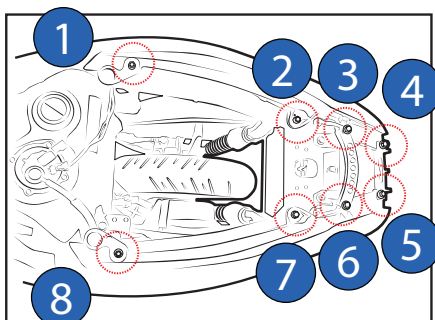

# MOUNTING INSTRUCTIONS

6

Remove the rear fairing on both side by loosening the six screws (1)(2)(3)(4)(5)(6). Then loosen the lower two screws (7)(8) and loosen the six screws on the inside of the rear fairing on both side (9)(10)(11)(12)(13)(14).

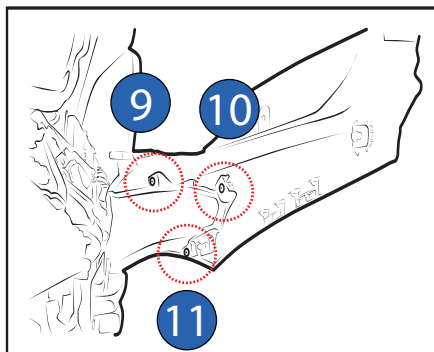
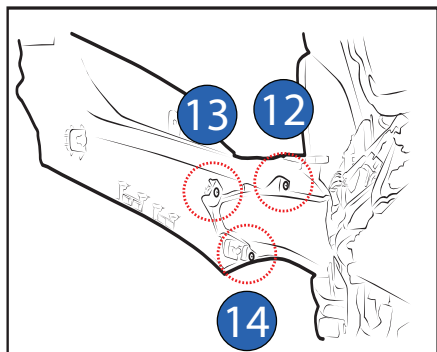
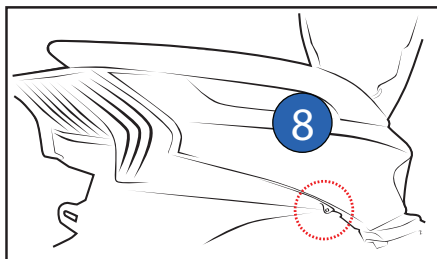
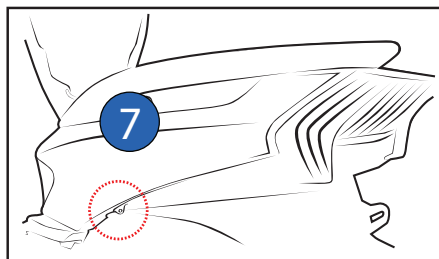
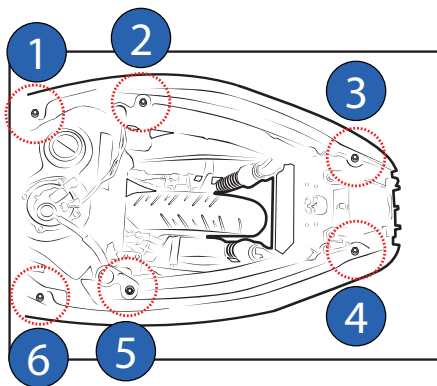

# MOUNTING INSTRUCTIONS

7

Release the tail lamp by loosening the six screws (1)(2)(3)(4)(5)(6)

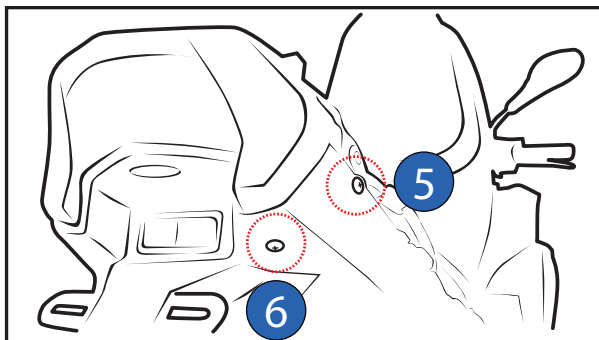
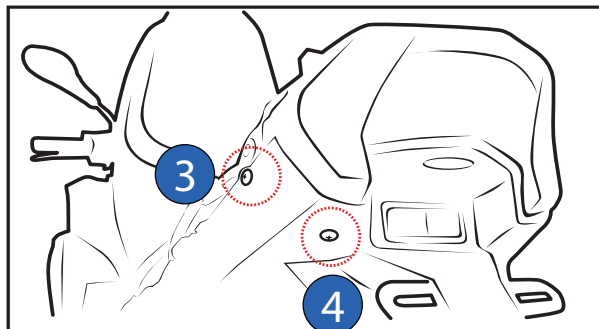
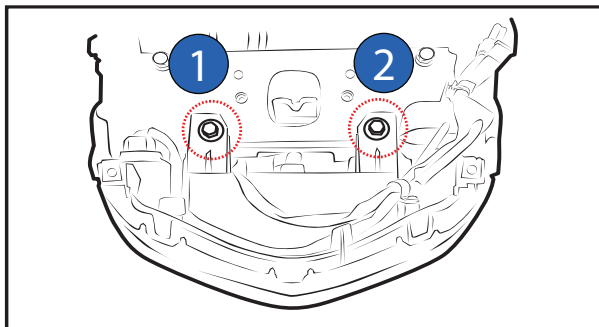

# MOUNTING INSTRUCTIONS

8

Remove the center rear fender by loosening the two screws (1)(2).

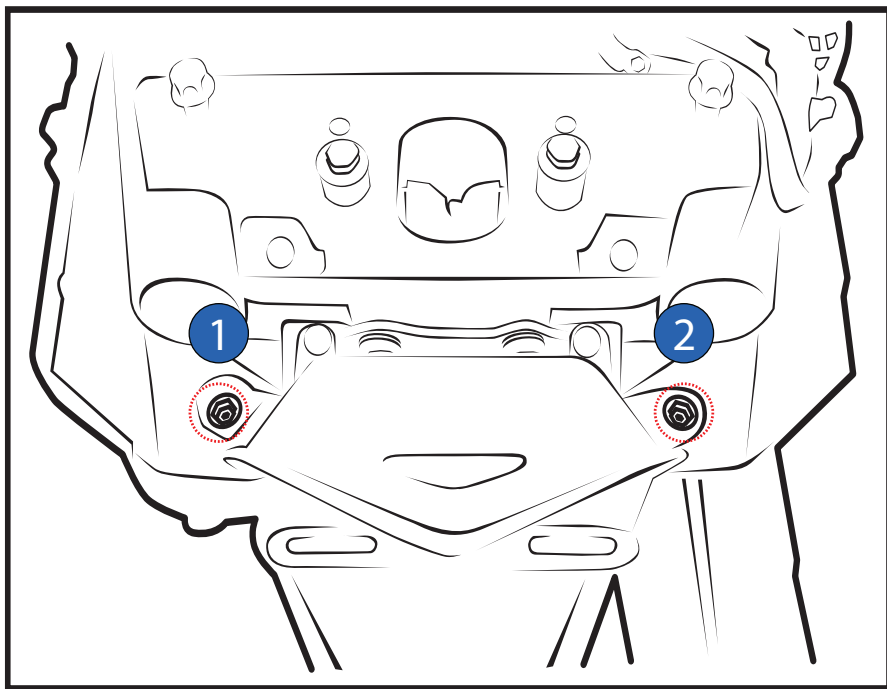

# MOUNTING INSTRUCTIONS

9

Remove the rear fender by loosening the four screws (1)(2)(3)(4).

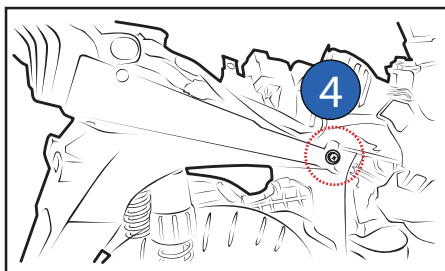
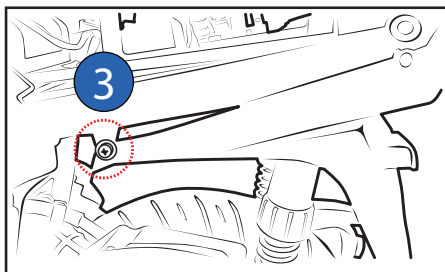



# MOUNTING INSTRUCTIONS

## 10

Remove the exhaust pipe by loosening the three screws (1)(2)(3) and loosen the pipe clamp.

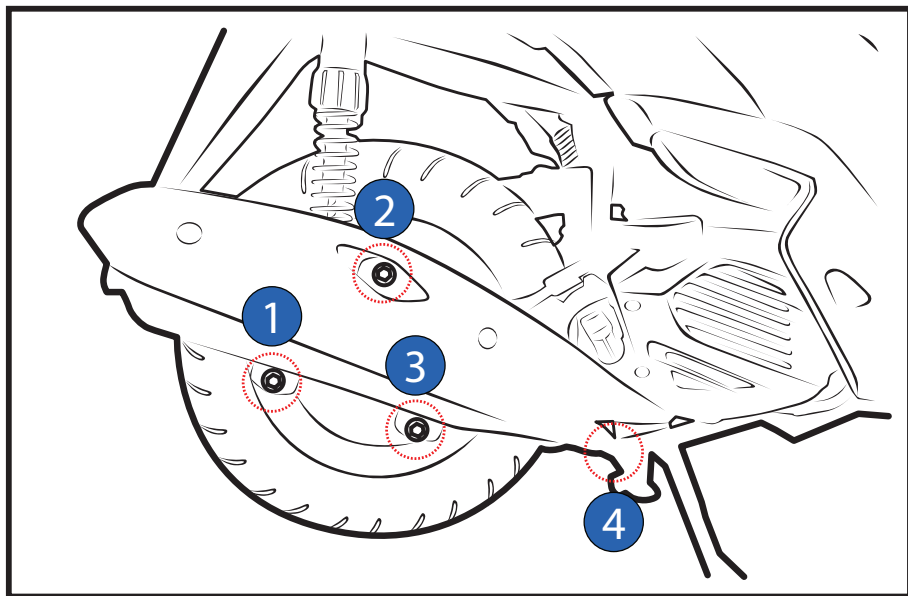

# MOUNTING INSTRUCTIONS

11

Remove the standard shock on both sides by loosening the upper nut and the lower bolt (1)(2)(3)(4).

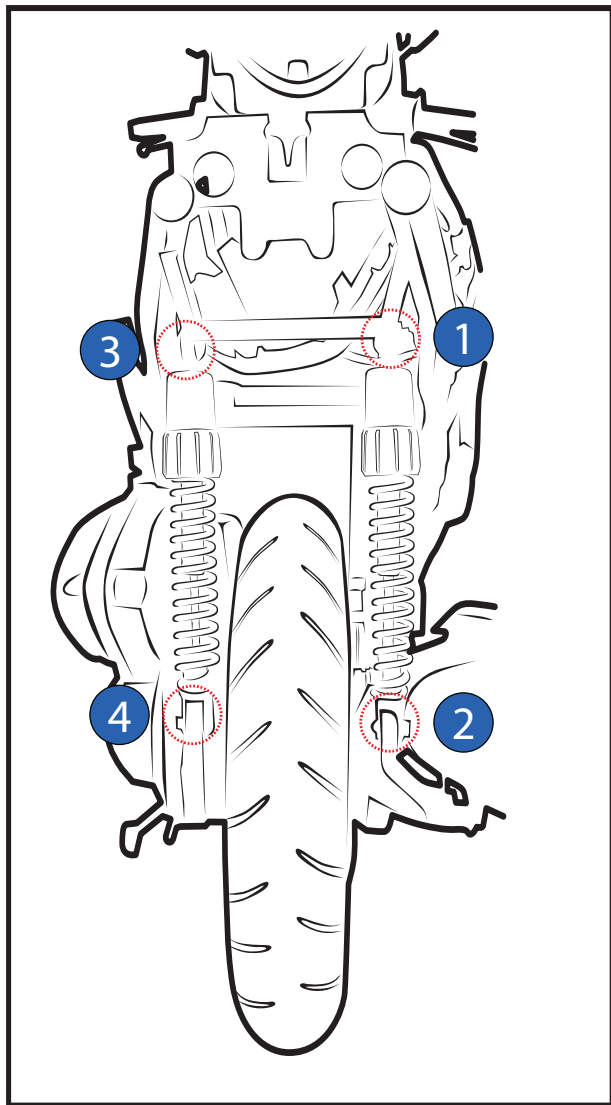

# MOUNTING INSTRUCTIONS

## 12

Place the spacer and the O-ring onto the end eye of shock absorber as per picture below.

Install the Öhlins shock absorber by the cylinder head downward.

Tighten the upper nut (1) and the lower screw (2) as per torque value specified in YAMAHA service manual.

Reverse all procedures as required.

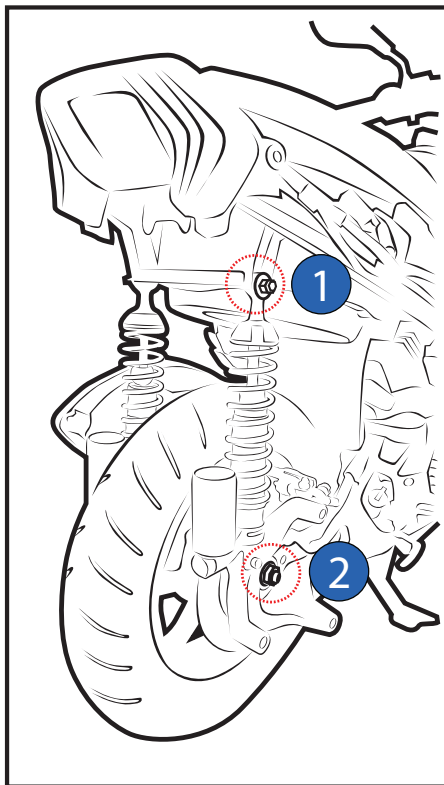
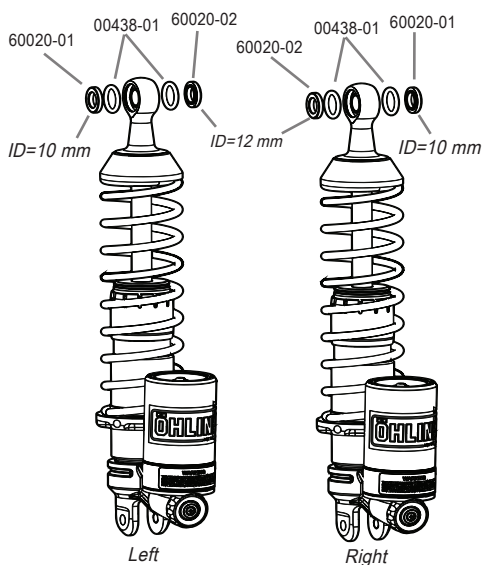

### **Note!**

Lower the vehicle so that the suspension is slightly compressed before tightening the screws.

### **Caution!**

Ensure that all screws are tightened to the correct torque and that nothing fouls or restricts movement of the shock absorber when the suspension is fully compressed or extended.

# ADJUSTMENTS

**⚠ Warning!**

*Before riding, always make sure that the basic settings made by Öhlins are according to recommended Set-up Data. Read about adjustments and setting up in the Öhlins Owner's Manual before you make any adjustments. Contact an Öhlins dealer if you have any questions about setting up.*

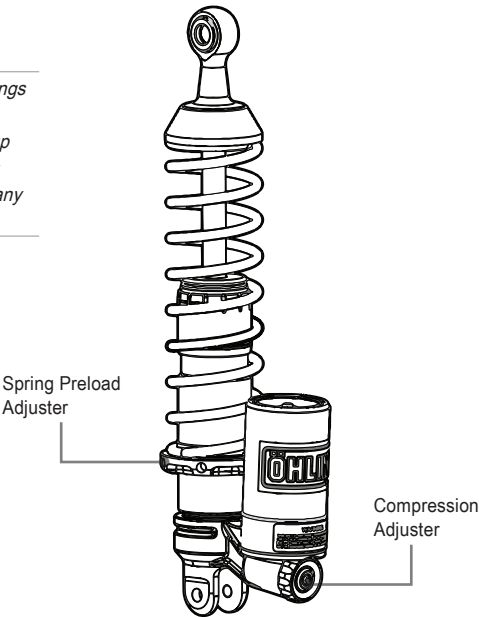

# SET-UP DATA

**Recommended set-up**

Spring Preload ..... 10 mm  
Compression adjuster ..... 10 Clicks

**Shock absorber data**

Length ..... 340 mm  
Stroke ..... 98 mm

**Spring**

Part No ..... 60281-19  
Free spring length ..... 200 mm

👁 Öhlins products are subject to continuous improvement and development, therefore, although these instructions include the most up-to-date information available at the time of printing, minor updates may occur.

To find the latest information contact an Öhlins distributor. Please contact Öhlins if you have any questions regarding the contents in this document.

Part no. MI\_YA110013\_EN\_0  
Issued 2014-10-21

© Öhlins Asia Co. Ltd. All rights reserved. Any reprinting or unauthorized use without the written permission of Öhlins Racing AB is prohibited.

Öhlins Asia Co. Ltd  
700/937 Moo5, Tambol Nongkhaga,  
Amphur Phantong, Chonburi Province  
20160 Thailand



[www.ohlins.com](http://www.ohlins.com)